

Design Guide

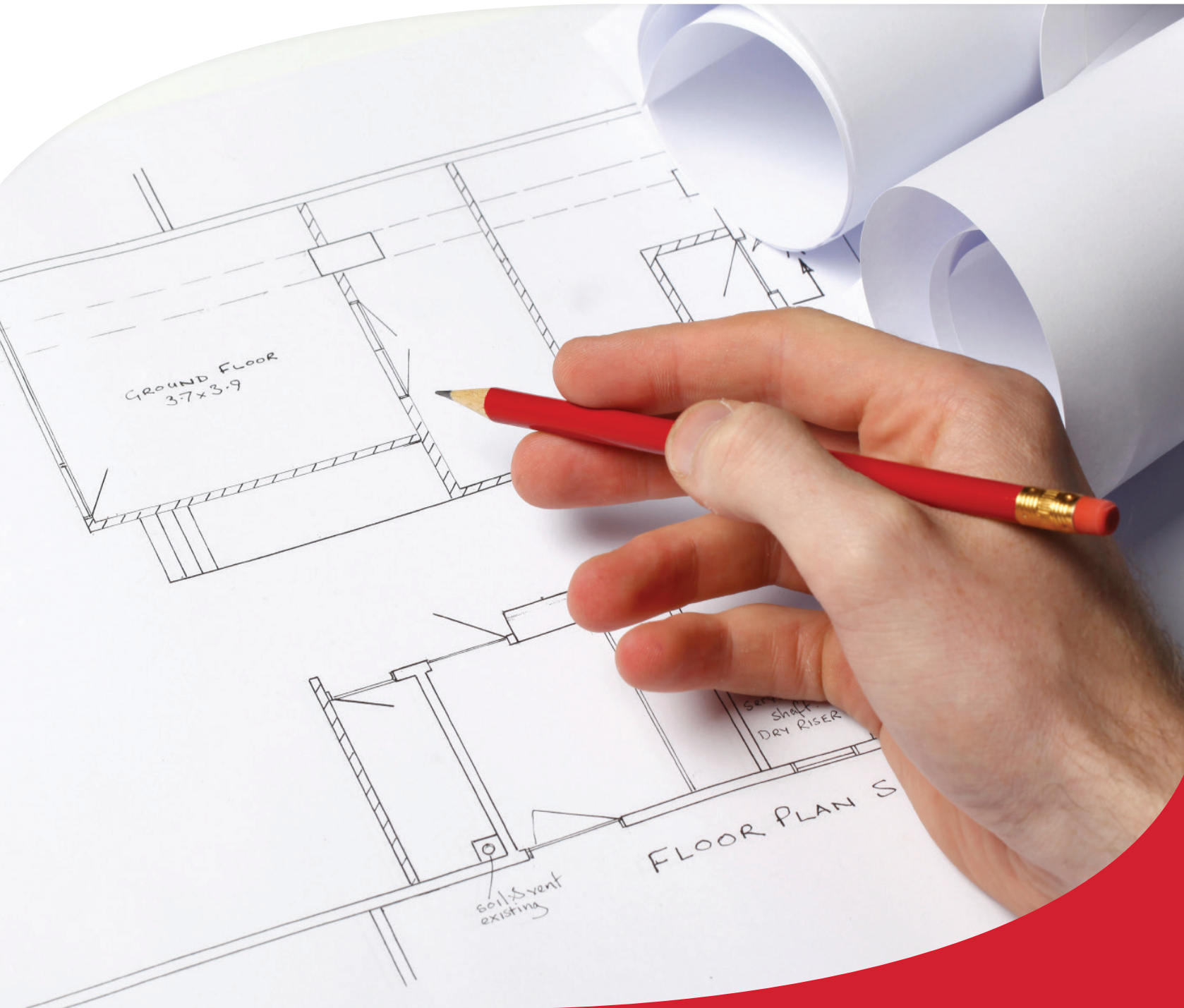

www.warmup.com

Warmup[®]

The world's best-selling floor heating brand™

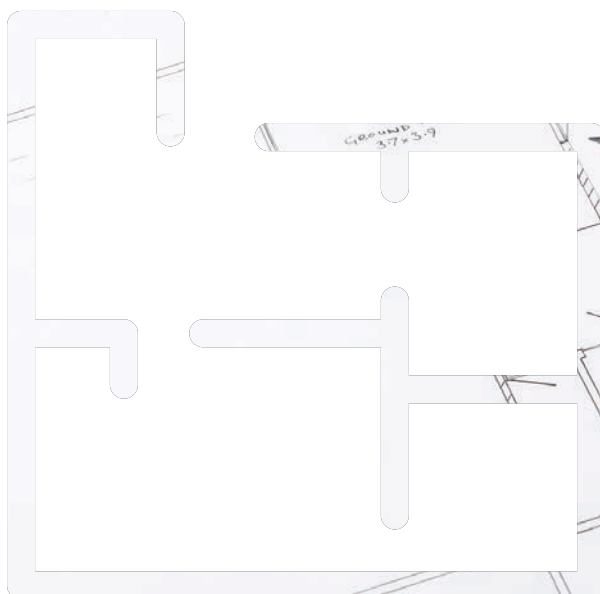

The Design Guide is a selection of real layouts and projects with MSRP pricing and product information.

Use it with clients to show them how affordable floor heating and snow melting can be.

Contact Warmup if you have questions:

T: (888)927-6333 | E: us@warmup.com

Fax or Send the order to:

F: (888) 927-4721 | E: us@warmup.com

Mats vs. Cables Comparison

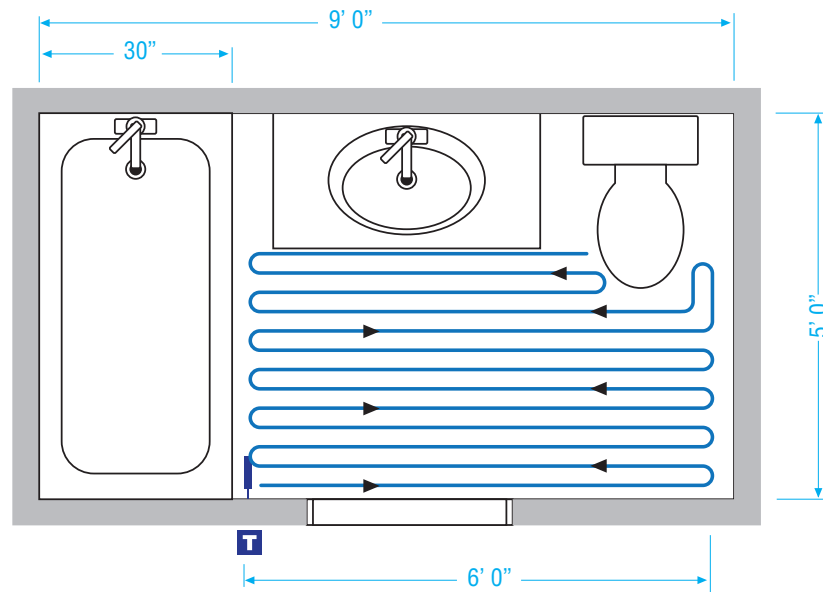

Size 45 sq. ft.		Price \$436		Type NADWS Cable	
Total Room Area	45 sq. ft.			Specifications	
Surface to be Heated	22 sq. ft.			Voltage	120
Heating System	NADWS 120-280 Loose Wire System	\$227.00		Amps	2.3
Thermostat	4iE Touch Screen Thermostat w/GFCI	\$209.00		Monthly Cost to Run	\$3.15
		Total	\$436.00	Total BTU Equivalent	952



Flexibility:

You can vary the spacing of the cables to customize the output. For example, space the cable 2" by the vanity where you stand and 4" in other traffic areas.



Mats vs. Cables Comparison

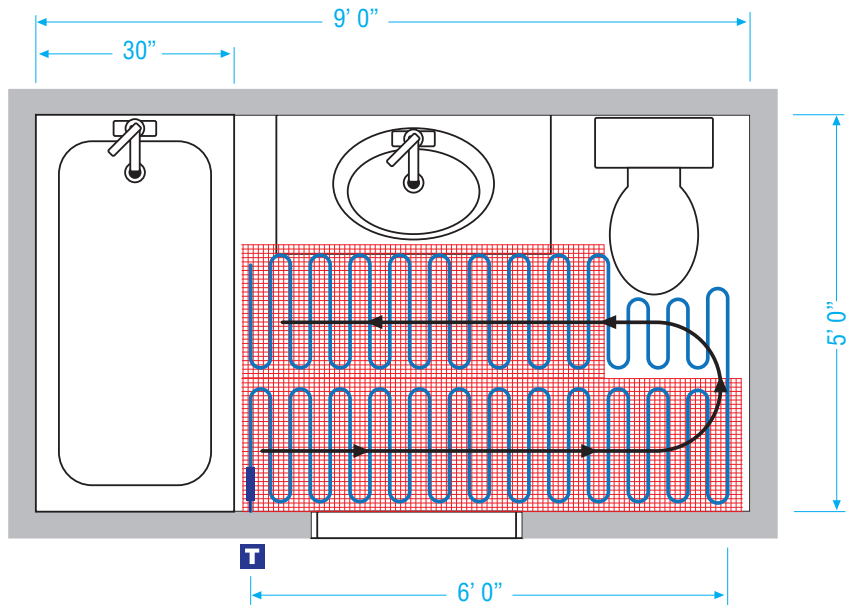

Size 45 sq. ft.		Price \$488		Type NADWM Mat	
Total Room Area	45 sq. ft.			Specifications	
Surface to be Heated	22 sq. ft.			Voltage	120
Heating System	NADWM 120-280 Floor Heating Mat	\$279.00		Amps	2.3
Thermostat	4iE Touch Screen Thermostat w/GFCI	\$209.00		Monthly Cost to Run	\$3.15
		Total	\$488.00	Total BTU Equivalent	952

Primary Heating:

Consider Warmup's optional Insulation Boards for \$136.00 in this room to provide primary heating by reducing heat loss over slabs and poorly insulated subfloors. Highly recommended to ensure faster heat-up times and retention.



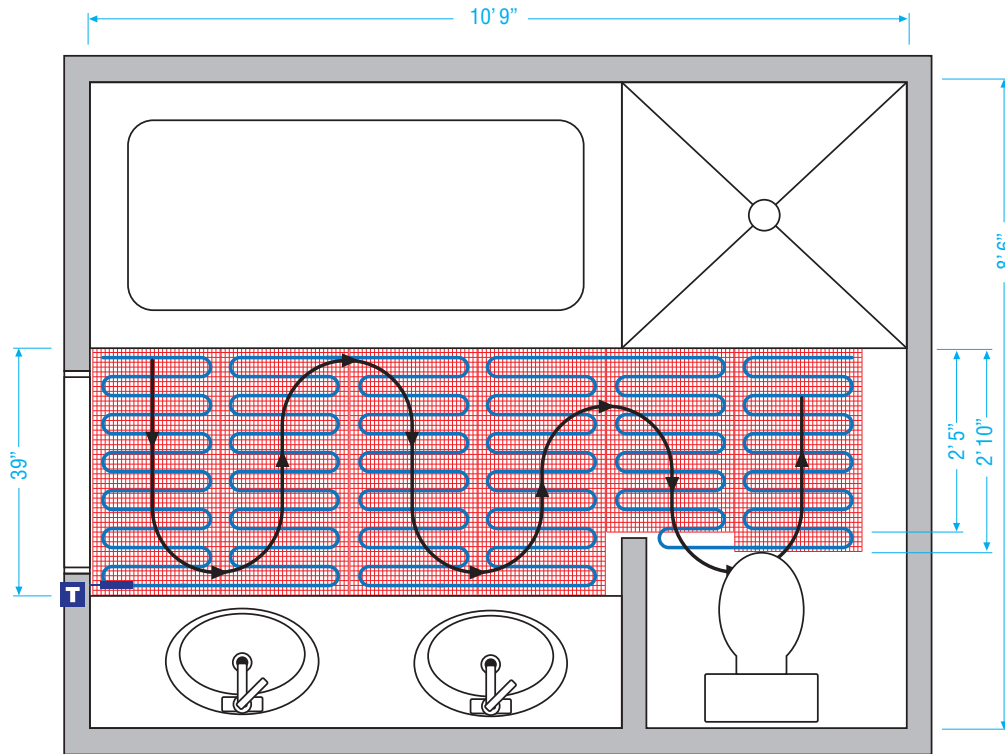

Size 90 sq. ft.		Price \$717		Type NADWM Mat	
Total Room Area	90 sq. ft.			Specifications	
Surface to be Heated	35 sq. ft.			Voltage	120
Heating System	NADWM 120-700 Floor Heating Mat	\$508.00		Amps	5.8
Thermostat	4iE Touch Screen Thermostat w/GFCI	\$209.00		Monthly Cost to Run	\$4.80
		Total	\$717.00	Total BTU Equivalent	2,380

Heat in the Shower:

Did you know Warmup is approved for installation in showers and shower benches? This is a great improvement to steam showers and regular showers alike! See page50 for Showers.



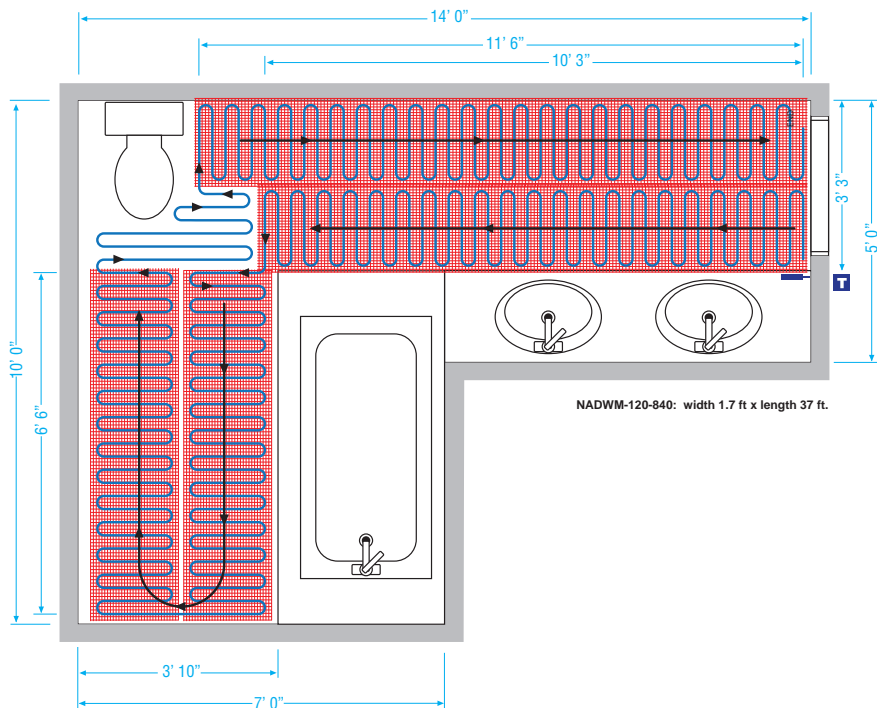

Size		Price		Type	
105 sq. ft.		\$800		NADWM Mat	
Total Room Area	105 sq. ft.			Specifications	
Surface to be Heated	63 sq. ft.			Voltage	120
Heating System	NADWM 120-840 Floor Heating Mat	\$591.00		Amps	7.0
Thermostat	4iE Touch Screen Thermostat w/GFCI	\$209.00		Monthly Cost to Run	\$5.60
		Total	\$800.00	Total BTU Equivalent	2,638

Standard Mat = Custom Layout

Not only can mats be cut-and-turned to fit any layout, but you can also remove the cable from the mesh where necessary to go around vents, pipes and obstacles.



Heating the Shower and Bench

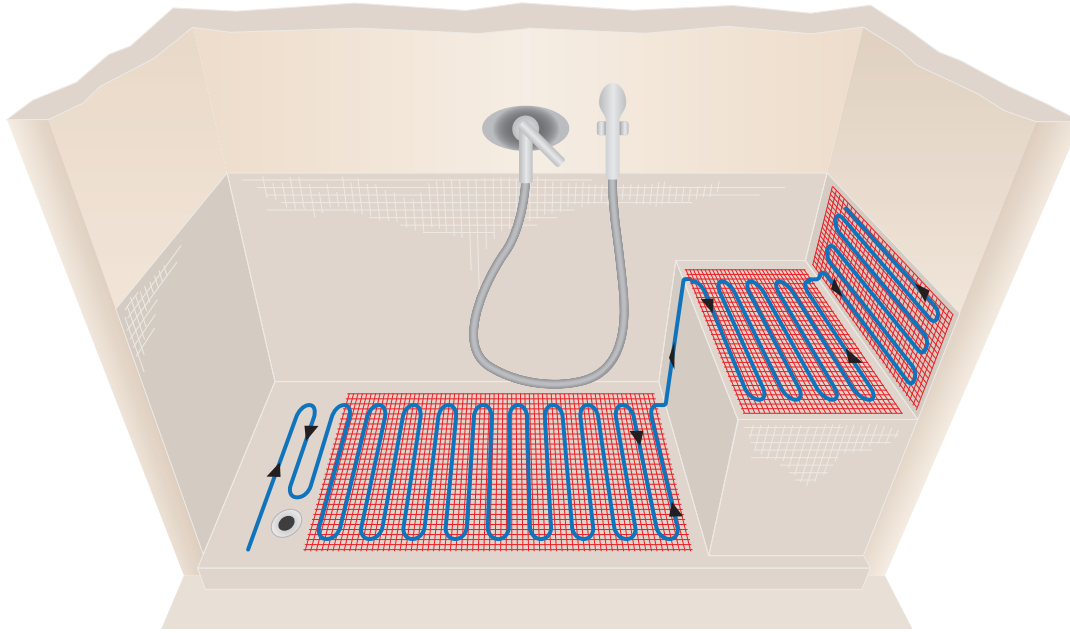

*Always check with building codes of practice before installing heating products in the shower.

Size 15 sq. ft.		Price \$248		Type NADWM Mat	
Total Area w/Bench	15 sq. ft.			Specifications	
Surface to be Heated	15 sq. ft.			Voltage	120
Heating System	NADWM 120-210 Floor Heating Mat	\$248.00		Amps	1.8
Thermostat	(Connect to bathroom thermostat)			Monthly Cost to Run	N/A
		Total	\$248.00	Total BTU Equivalent	714

Did You Know?

Warmup cables and mats are coated with advanced fluoropolymers that make them entirely watertight. They can be installed in showers and provide the soothing luxury of a spa bathroom!

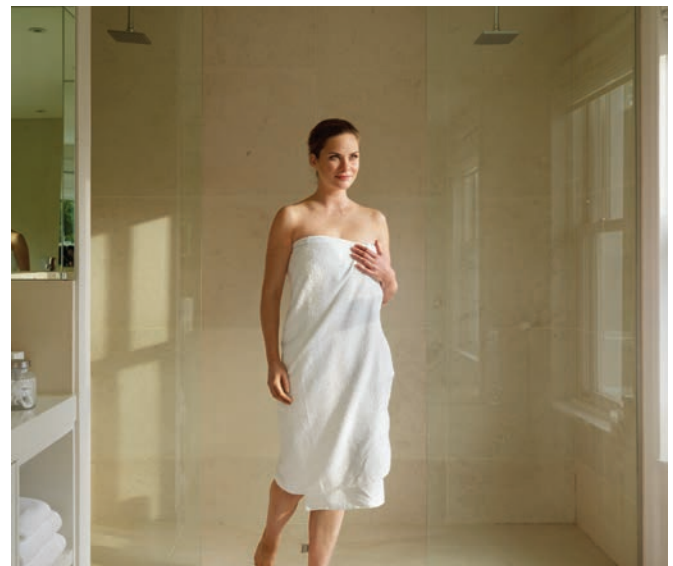
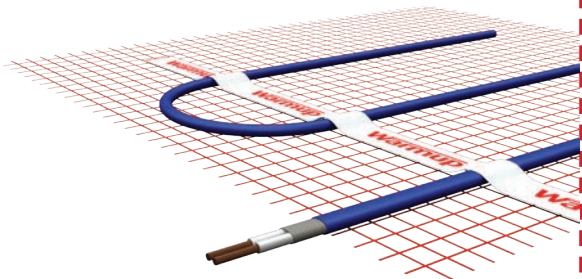

Large Custom Bath

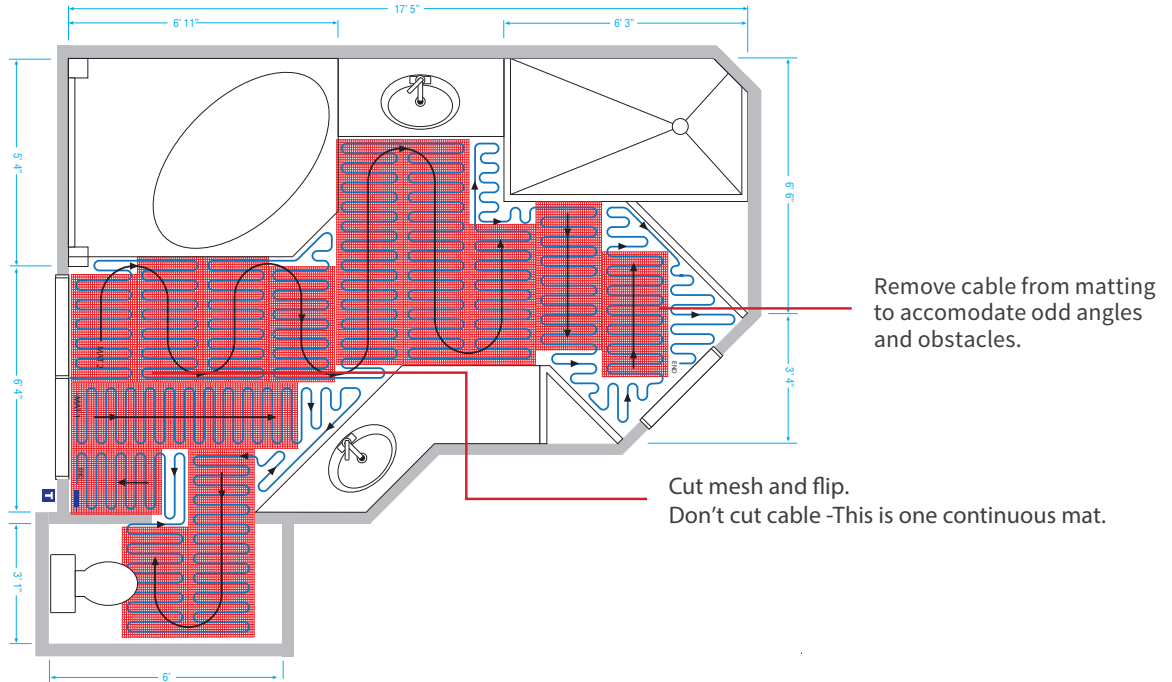

Size 160 sq. ft.		Price \$1,039		Type NADWM Mat	
Total Room Area	160 sq. ft.			Specifications	
Surface to be Heated	90 sq. ft.			Voltage	120
Heating System	NADWM 120-1260 Floor Heating Mat	\$830.00		Amps	10.5
Thermostat	4iE Touch-Screen Thermostat w/GFCI	\$209.00		Monthly Cost to Run	\$6.80
		Total	\$1,039.00	Total BTU Equivalent	4,284

Did you know

Warmup offers Mirror Defogger mats for under \$100?

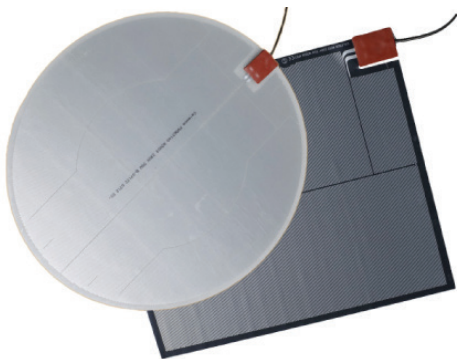

Large Custom Bath

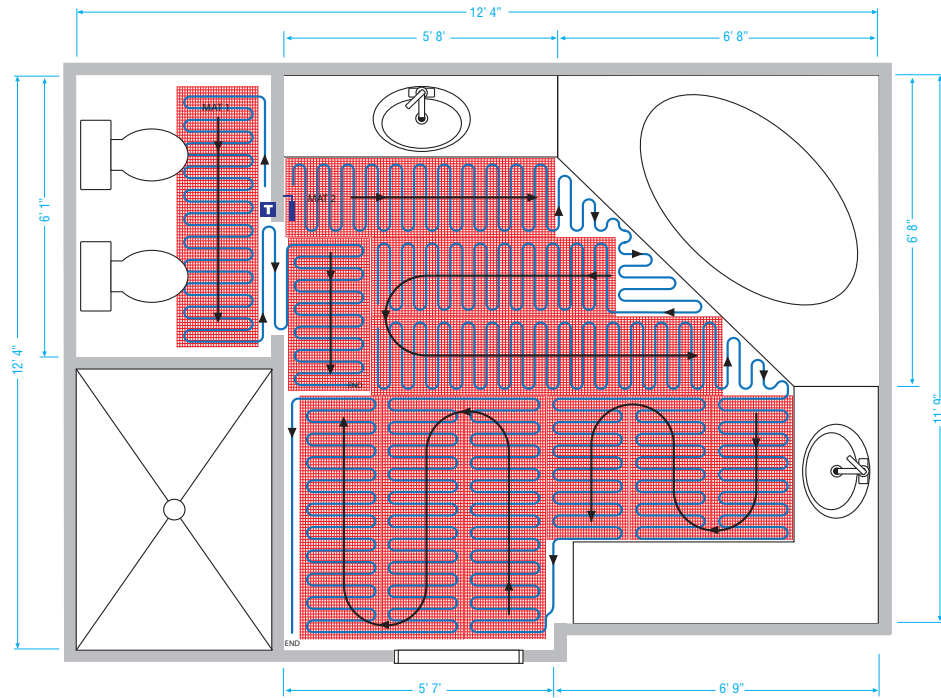

Size 180 sq. ft.		Price \$1,195		Type NADWM Mat	
Total Room Area	180 sq. ft.			Specifications	
Surface to be Heated	110 sq. ft.			Voltage	120
Heating System	NADWM 120-1540 Floor Heating Mat	\$986.00		Amps	12.8
Thermostat	4iE Touch Screen Thermostat w/GFCI	\$209.00		Monthly Cost to Run	\$7.50
		Total	\$1,195.00	Total BTU Equivalent	5,236

Add Insulation Boards for \$467

Consider Warmup's optional Insulation Boards for \$467.00 in this room to provide primary heating by reducing heat loss over slabs and poorly insulated subfloors.

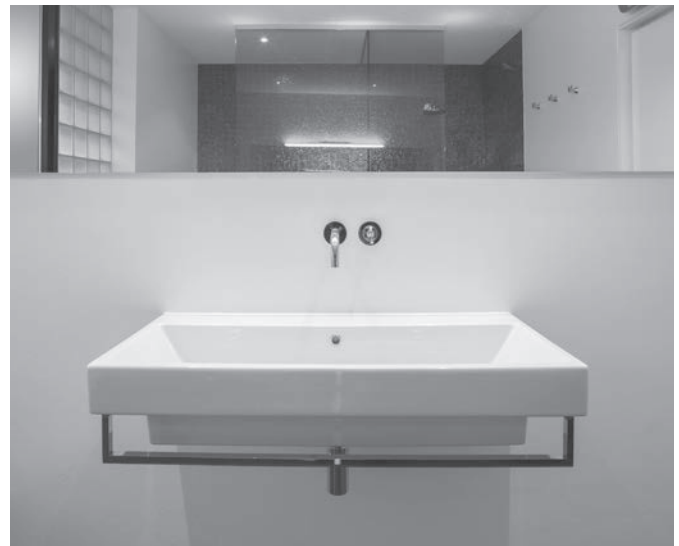
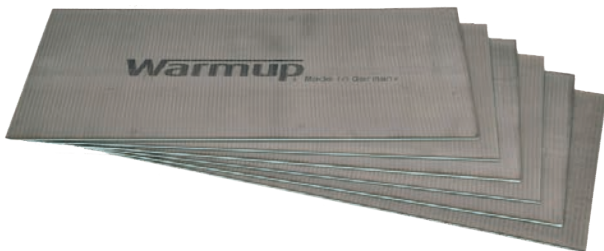

Large Custom Bath

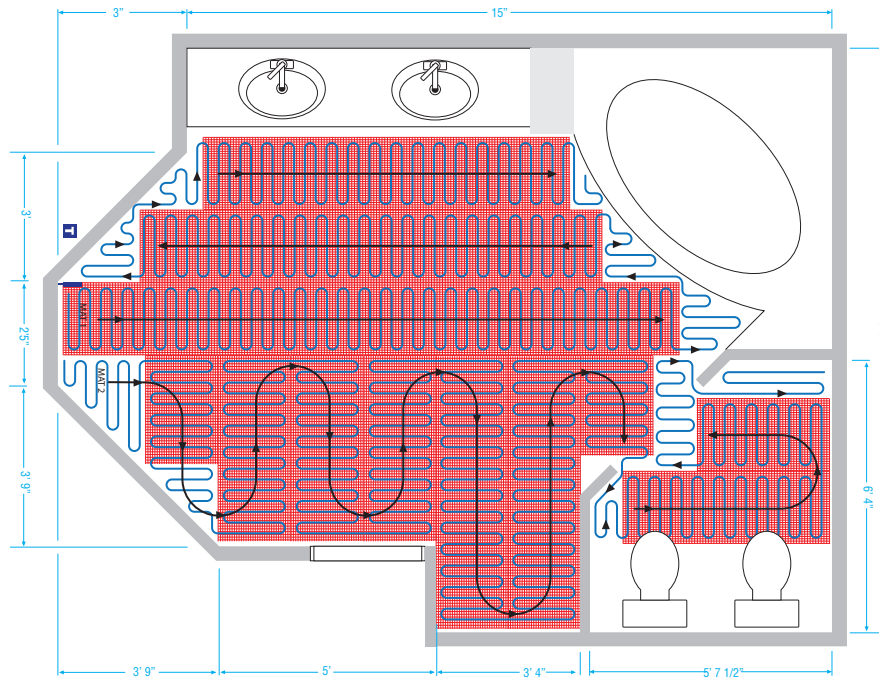

Size		Price		Type	
200 sq. ft.		\$1,247		NADWM Mat	
Total Room Area	200 sq. ft.			Specifications	
Surface to be Heated	120 sq. ft.			Voltage	120
Heating System	NADWM 120-1620 Floor Heating Mat	\$1,038.00		Amps	13.5
Thermostat	4iE Touch Screen Thermostat w/GFCI	\$209.00		Monthly Cost to Run	\$8.10
		Total	\$1,247.00	Total BTU Equivalent	5,508

Add Insulation Boards for \$510

Consider Warmup's optional Insulation Boards for \$510.00 in this room to provide primary heating by reducing heat loss over slabs and poorly insulated subfloors.

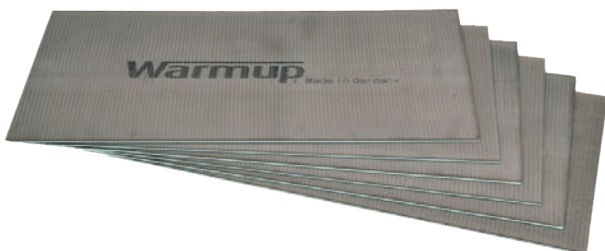

Kitchen with NADWM mats

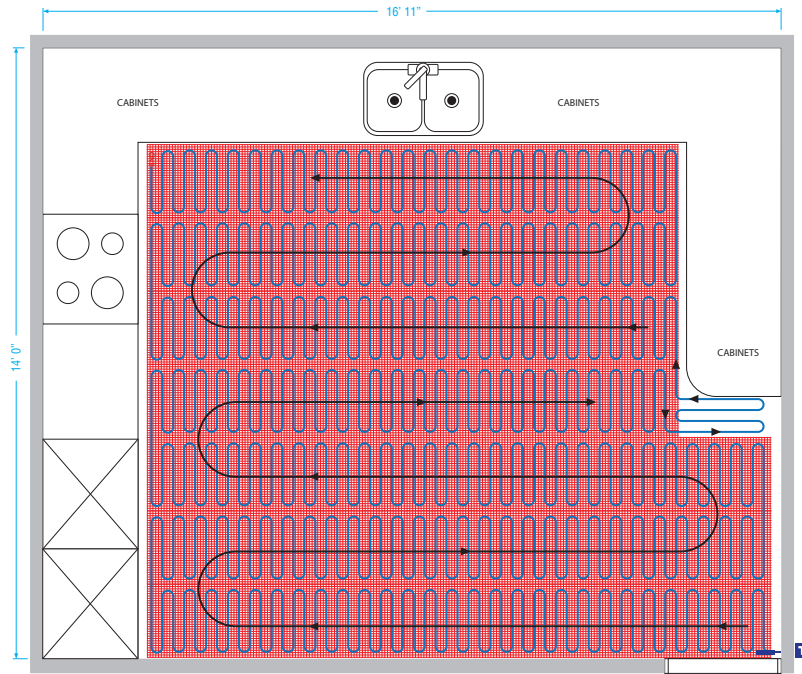

NADWM-240-2100: width 1.7 ft x length 91 ft.

Size		Price		Type	
225 sq. ft.		\$1,515		NADWM Mat	
Total Room Area	225 sq. ft.	Specifications			
Surface to be Heated	150 sq. ft.	Voltage	240	Amps	8.8
Heating System	NADWM 240-2100 Floor Heating Mat	\$1,246.00	Monthly Cost to Run	\$9.20	
Thermostat	4iE Smart-WiFi Thermostat	\$269.00	Total BTU Equivalent	7,140	
		Total	\$1,515.00		

Did You Know?

Warmup NADWM Mats will provide for a fast installation and even heat throughout the room.

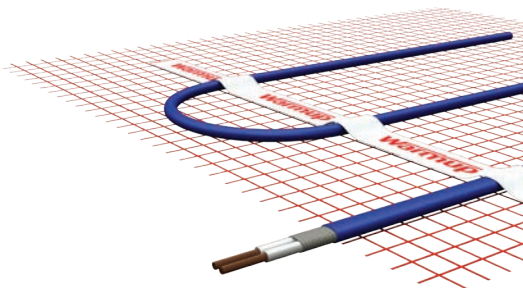

Kitchen with NADWS cables

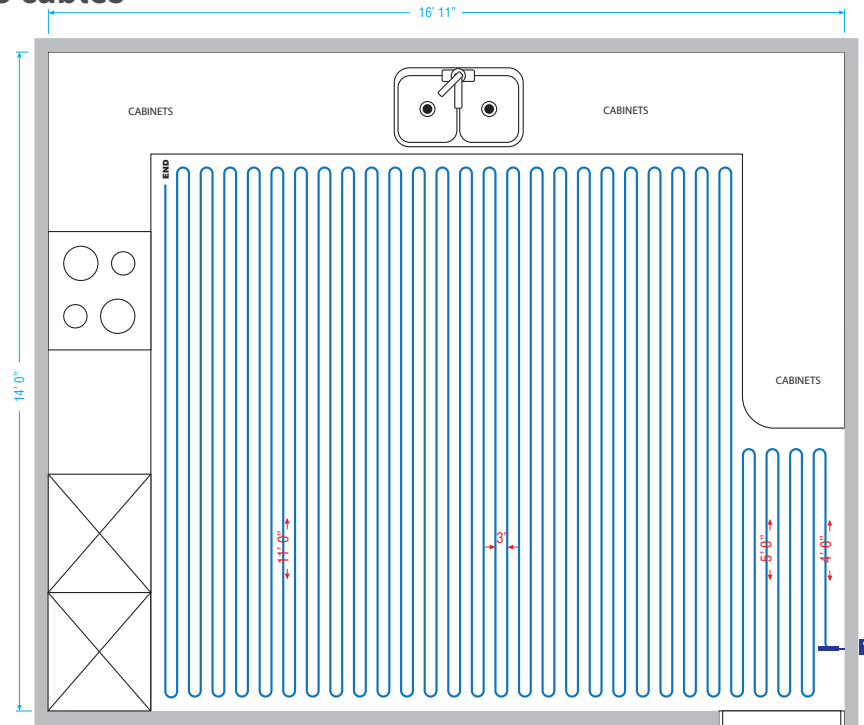

kitchen 237.51 sq.ft.
matt/cable area 162.40 sqft

NADWS-240-2100: length 600 ft.

Size	Price	Type	
225 sq. ft.	\$1,099	NADWS Cable	
Total Room Area	225 sq. ft.	Specifications	
Surface to be Heated	150 sq. ft.	Voltage	240
Heating System	NADWS 240-2100 Loose Wire System	Amps	8.8
Thermostat	4iE Smart-WiFi Thermostat	Monthly Cost to Run	\$9.20
Total		Total BTU Equivalent	7,140
		\$1,099.00	

Did You Know?

Loose cable will allow some savings on material but will call for additional labor. This option is best for those seeking primary heating in the kitchen or looking to customize the cable spacing. For example, 2" spacing by the counters (more heat), and 4" spacing in the open space (less heat).

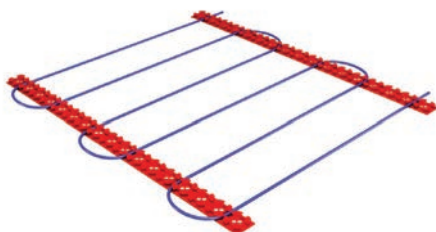

Kitchen with full coverage

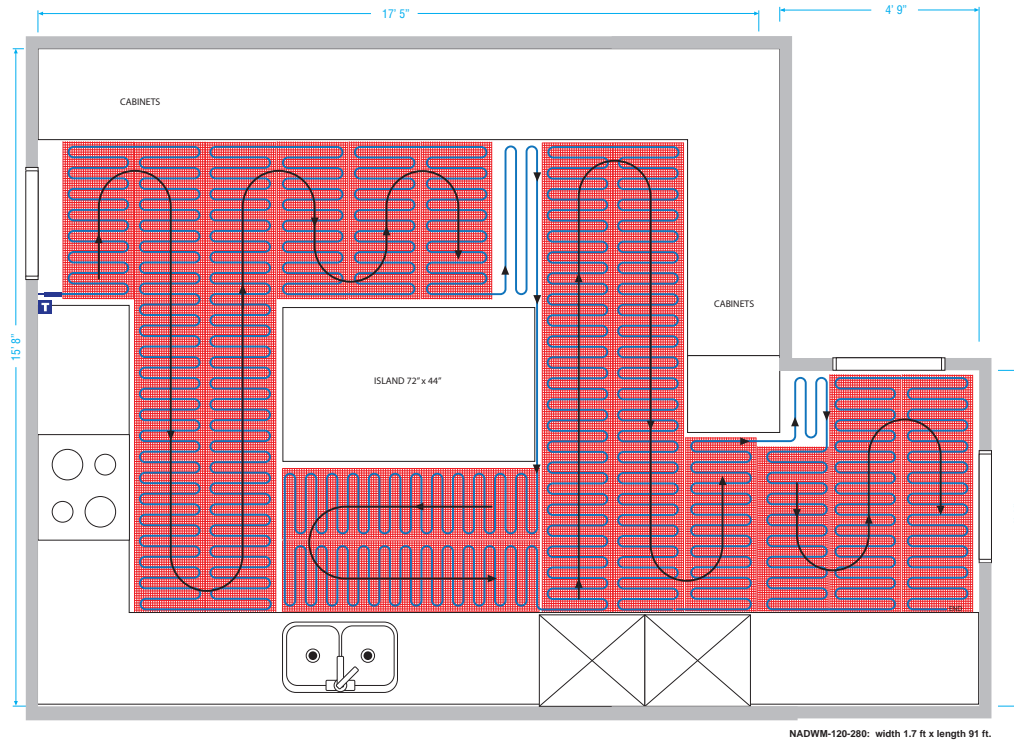

Size		Price		Type	
300 sq. ft.		\$1,515		NADWM Mat	
Total Room Area	300 sq. ft.	Specifications			
Surface to be Heated	150 sq. ft.	Voltage	240	Amps	8.8
Heating System	NADWM 240-2100 Floor Heating Mat	\$1,246.00	Monthly Cost to Run	\$9.20	
Thermostat	4iE Smart-WiFi Thermostat	\$269.00	Total BTU Equivalent	7,140	
		Total	\$1,515.00		

Did You Know?

Warmup can be the sole source of heat in your kitchen. This means you can keep the furnace several degrees lower and save energy when the family spends time in the kitchen.

Add Insulation Boards for maximum efficiency for \$637 for the entire room.



Warmup Radiant Floor Heating

Kitchen with partial coverage

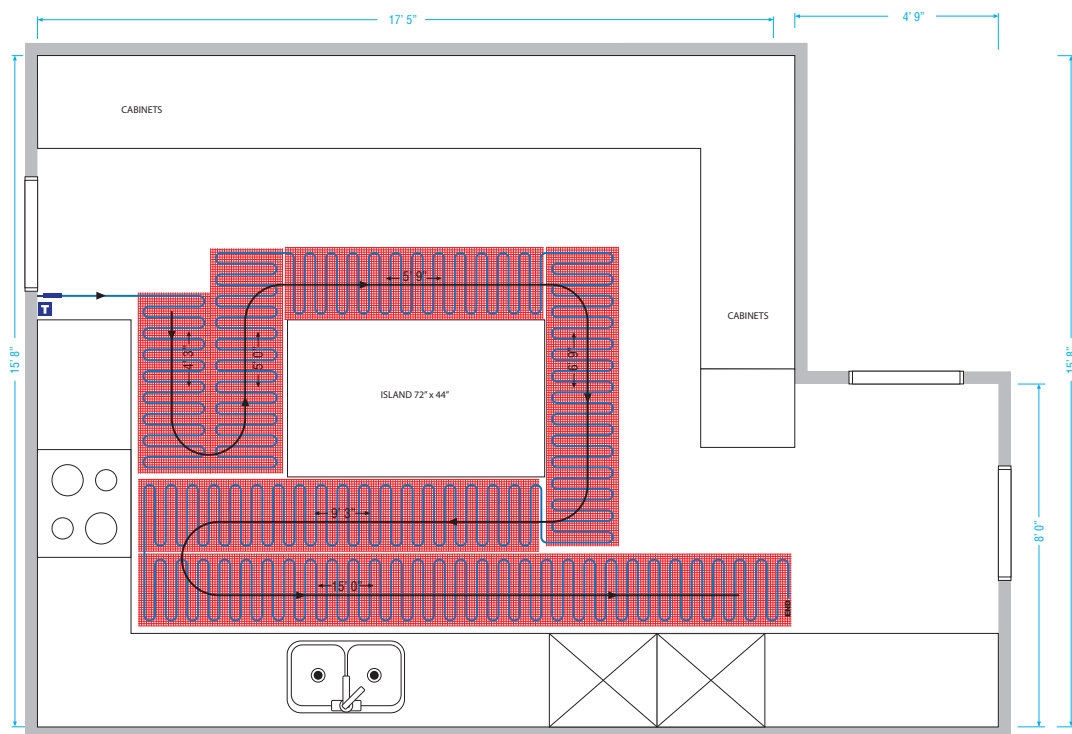

NADWM-240-1050: width 1.7 ft x length 46 ft.

Size		Price		Type	
300 sq. ft.		\$885		NADWM Mat	
Total Room Area	300 sq. ft.	Specifications			
Surface to be Heated	75 sq. ft.	Voltage	120		
Heating System	NADWM 120-1050 Floor Heating Mat	\$716.00	Amps	8.8	
Thermostat	4iE Smart-WiFi Thermostat	\$269.00	Monthly Cost to Run	\$5.80	
		Total	\$885.00	Total BTU Equivalent	3,500

Heat Where You Need It:

In this unique example, we show that heated floors can be yours at a fraction of the cost. Unless primary heating is the goal, there is no need to cover every square inch of the room. Place the heating mats in the high-traffic areas in order to provide heat where you really need it most.



Sunroom with Engineered Wood

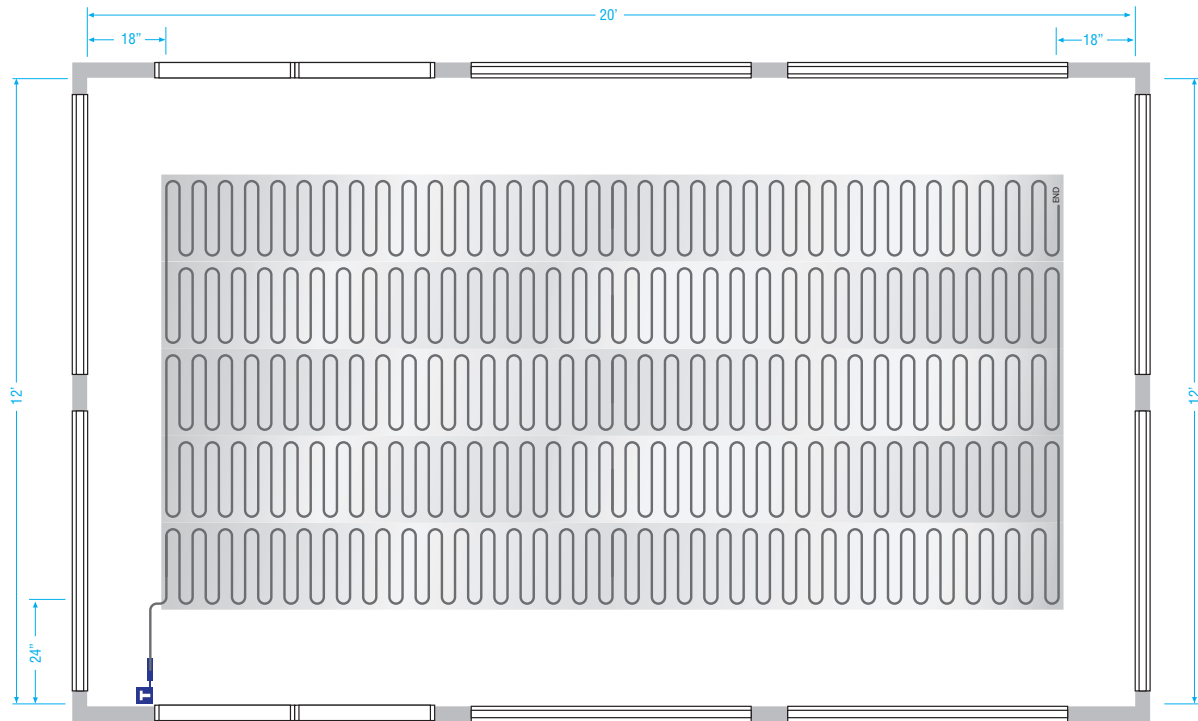

Size 240 sq. ft.		Price \$1,652		Type FOIL under wood	
Total Room Area	240 sq. ft.			Specifications	
Surface to be Heated	140 sq. ft.			Voltage	240
Heating System	Foil 140-240 Foil Heating Mat	\$1,383.00		Amps	7.0
Thermostat	4iE Smart-WiFi Thermostat	\$269.00		Monthly Cost to Run	\$8.00
		Total	\$1,652.00	Total BTU Equivalent	5,700

Wood, Laminates and Carpet:

Foil mats require no thinset or adhesive and are placed directly between the subfloor and the LVT or Laminate planks. FOIL products are also approved for Carpet installations.



Bedroom with FOIL in U Shape

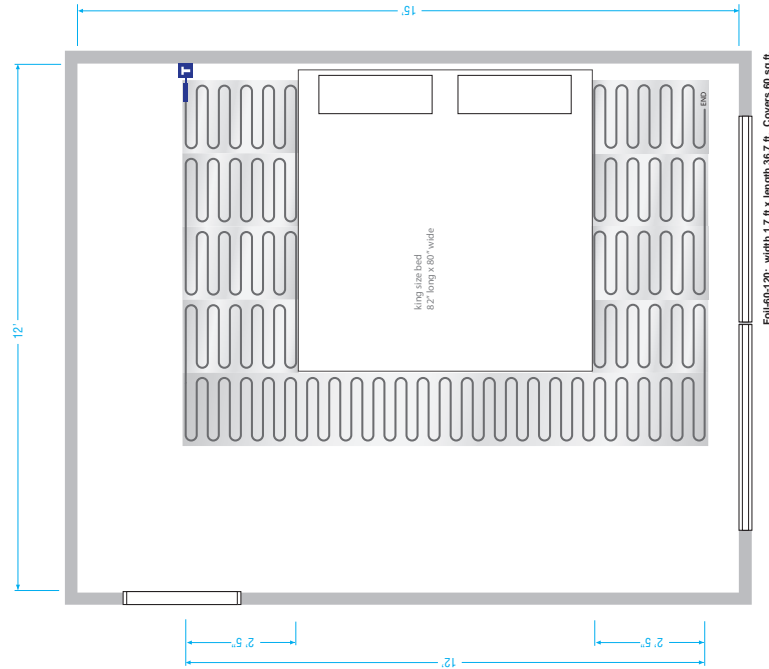

Size 180 sq. ft.		Price \$861		Type Foil under carpet	
Total Room Area	180 sq. ft.			Specifications	
Surface to be Heated	60 sq. ft.			Voltage	120
Heating System	Foil 60-120 Foil Heating Mat	\$592.00		Amps	6
Thermostat	4iE Smart-WiFi Thermostat	\$269.00		Monthly Cost to Run	\$4.50
		Total	\$861.00	Total BTU Equivalent	2,500

FOIL Mats:

Can be cut and turned to accommodate all layouts and can be placed directly between the pad and the final flooring.



Basement: Full coverage with NADWM mats under tile

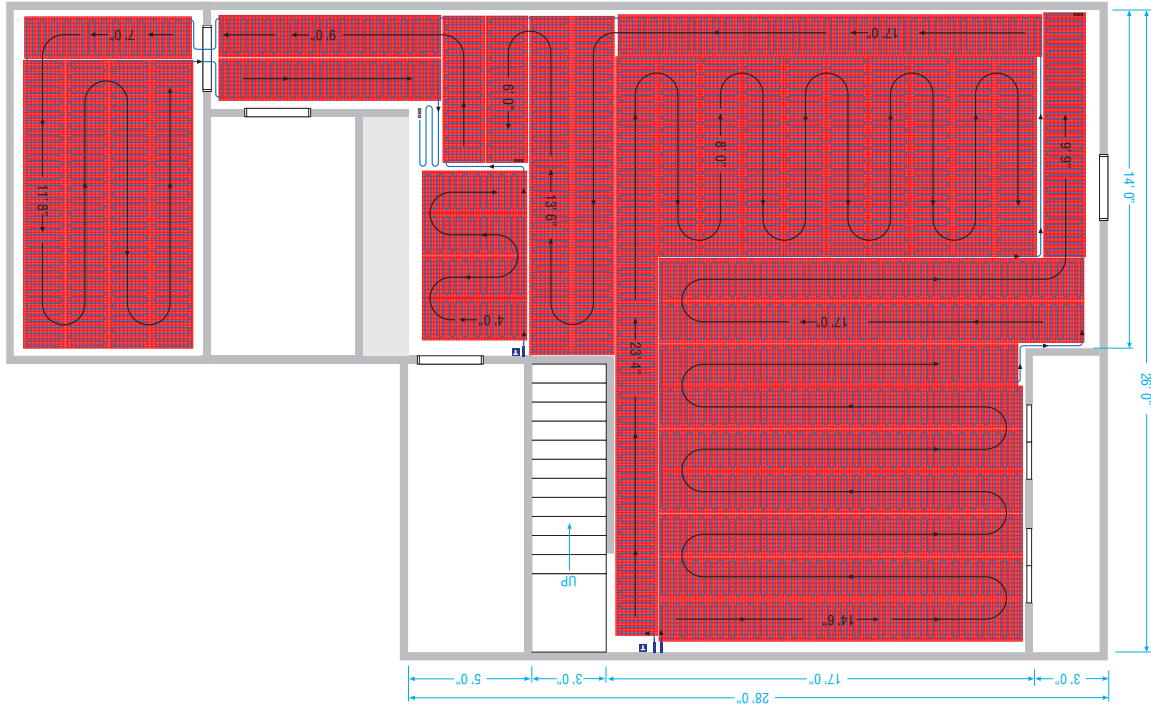

Size 800 sq. ft.		Price \$5,502		Type NADWM Mat	
Total Room Area	800 sq. ft.			Specifications	
Surface to be Heated	660 sq. ft.			Voltage	240
Heating System	NADWM 240-3080 (x 3)	\$4,986.00		Amps	38.4
Thermostat	4iE Smart-WiFi Thermostat	\$269.00		Monthly Cost to Run	\$42.00
Other	Relay 40 Box	\$247.00		Total BTU Equivalent	31,000
		Total	\$5,502.00		

Did You Know?

Add optional Insulation Boards for \$2,598.00 to reduce heat loss and improve results over slabs and poorly insulated subfloors.

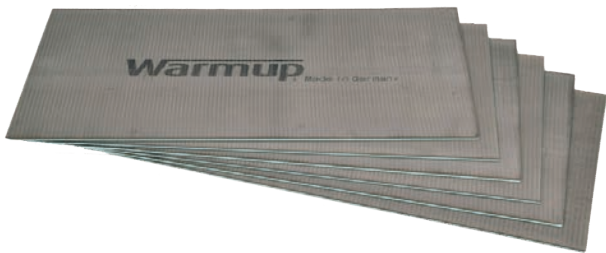

Basement: local coverage with FOIL under laminates

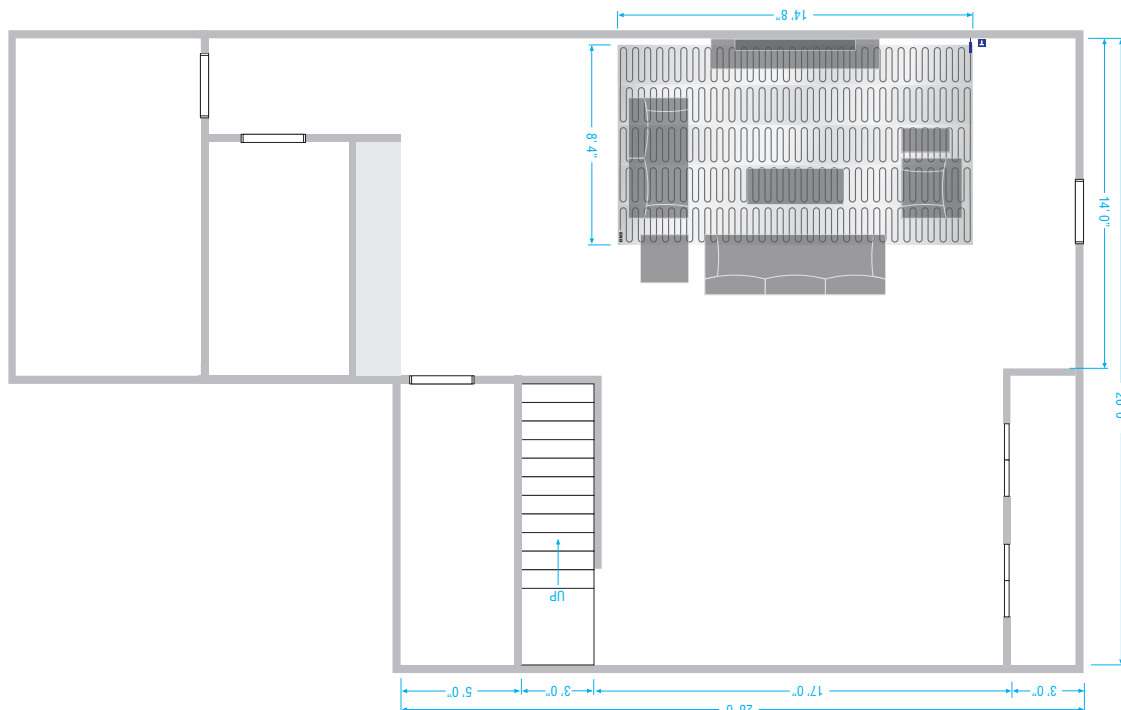

Size 800 sq. ft.		Price \$1,553		Type FOIL under carpet	
Total Room Area	800 sq. ft.			Specifications	
Surface to be Heated	130 sq. ft.			Voltage	240
Heating System	Foil 130-240 Foil Heating Mat	\$1,284.00		Amps	6.5
Thermostat	4iE Smart-WiFi Thermostat	\$269.00		Monthly Cost to Run	\$8.80
		Total	\$1,553.00	Total BTU Equivalent	5,300

Heat where you need it:

You don't have to spend big to feel warm. Install the heating system where you need it, here, in the basement's entertainment area by the TV.



Walkway, Stairs and Landing

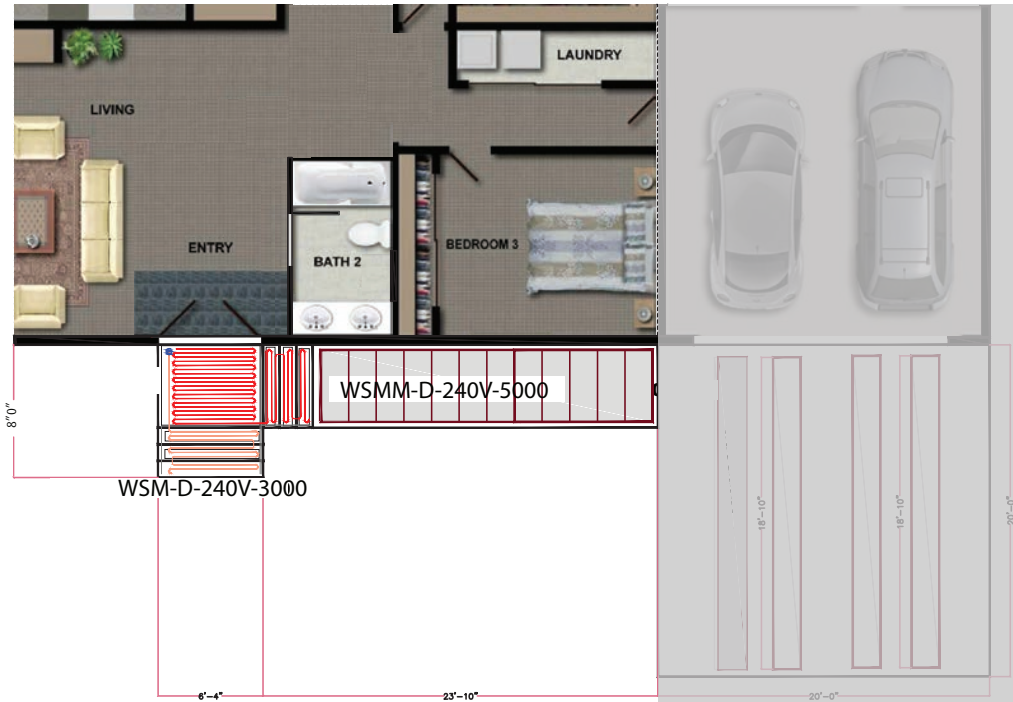

Size		Price		Type	
140 sq. ft.		\$1,871		WSM Snow Melt	
Total Area	140 sq. ft.			Specifications	
Surface to be Heated	120 sq. ft.			Voltage	240
Heating System (Steps)	WSM-D-240V-40W/3000	\$414.00		Amps	33A
Heating System (Walkway)	WSMM-D-240V-540W/5000	\$862.00		Monthly Cost to Run	\$75-\$95 per winter in Chicago
Controller	ASE-DS5 All-in-one Controller	\$595.00			
		Total	\$1,871.00		

Did You Know?

That salt damages concrete and kills grass and plants? Heating cables allow for a very easy set-up that is virtually maintenance-free. Controllers will automatically activate the cables during snow falls.



DS-5



Tire Track Heating Driveway

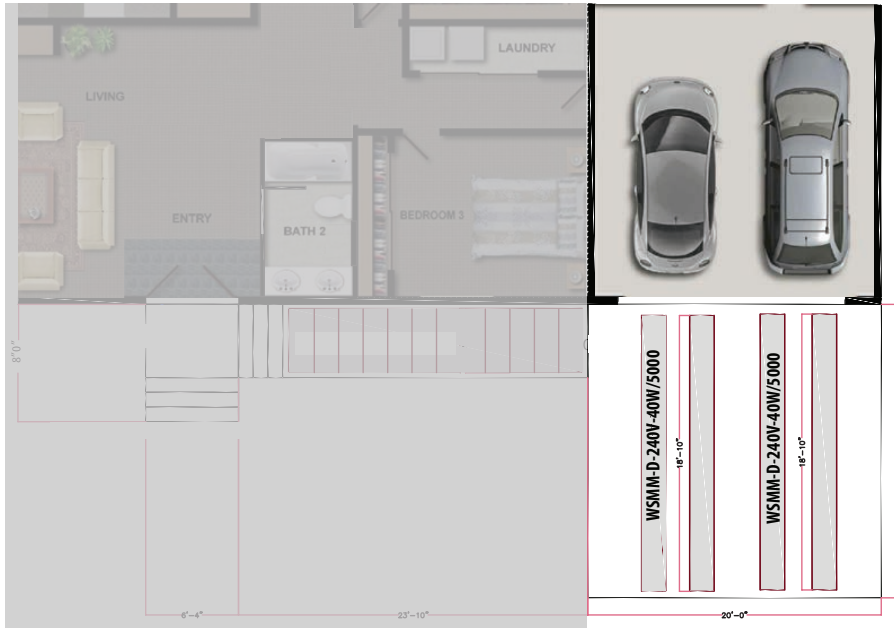

Size		Price		Type	
400 sq. ft.		\$2,319		WSM Snow Melt	
Total Area	400 sq. ft.			Specifications	
Surface to be Heated	160 sq. ft.			Voltage	240
Heating System	WSMM-D-240V-540W/5000 Snow Melt Mat (x 2)	\$1,724.00		Amps	42
Controller	ASE-DS5 All-in-one Controller	\$595.00		Monthly Cost to Run	\$150-\$185 per winter in Chicago
		Total	\$2,319.00		

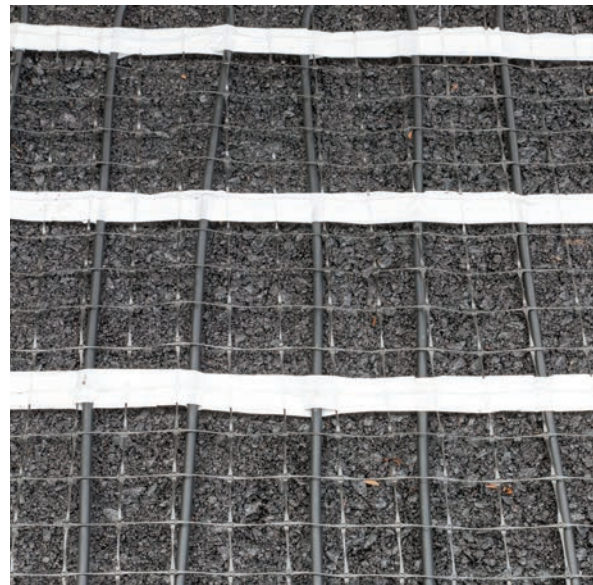

Driveway Full Coverage with Steps & Landing

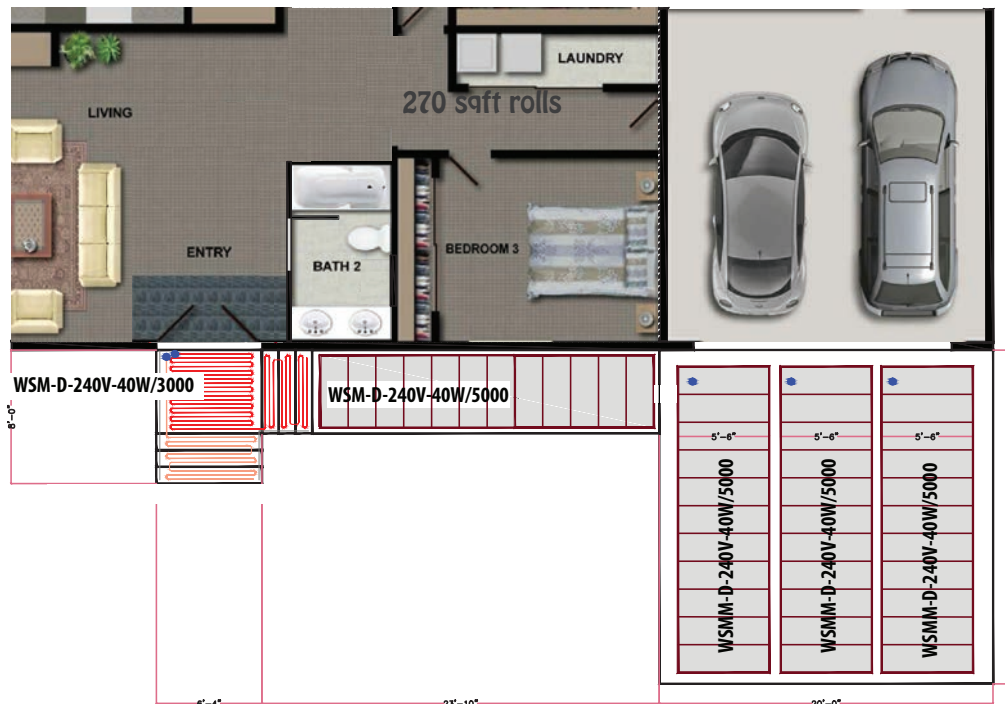

Size	Price	Type
400 sq. ft.	\$4,604	WSM Snow Melt
Total Area	400 sq. ft.	Specifications
Surface to be Heated	160 sq. ft.	Voltage
Heating Systems	Steps: WSM-D-240V-40W/3000 Snow Melt Cable (x2) \$828.00 Walkway: WSMM-D-240V-540W/5000 Snow Melt Mat (x1) \$862.00 Driveway: WSMM-D-240V-540W/5000 Snow Melt Mat (x2) \$1,724.00	Amps
Controller	DS-5 All-in-one Controller (x2) \$1,190.00	Monthly Cost to Run
	Total \$4,604.00	\$300-\$350 per winter in Chicago

Tip:

Warmup's unique RESIBOX-120 controller can help you reduce the amperage requirements and manage your project in zones. For example, with only half the available amperage, the RESIBOX can either heat the driveway first so you can head to work first thing in the morning, and the walkway later, so you can come home safe. The RESIBOX is completely plug-and-play with all the GFEP relays, contacts and connections, all in one convenient box.

MSRP \$3,693



Warmup

The world's **best-selling** floor heating brand™

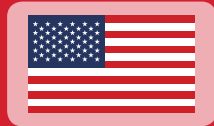

Warmup Inc.
52 Federal Road, Unit 1F
Danbury, CT 06810

T: 888 927 6333

F: 888 927 4721

www.warmup.com

us@warmup.com



Warmup Inc.
374 Wellington St W
Toronto, ON M5V 1E3

T: 905 990 2075

F: 905 366 7324

www.warmup.ca

ca@warmup.com